



IP-Enabled In-Ceiling Indoor Speaker

DW-SWSPC30iAM

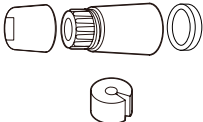

WHAT'S IN THE BOX

IP Ceiling Speaker		1	Quick Setup Guide		1
Waterproof Cap		1			

Download all your support materials and tools in one place.

1. Go to: <http://www.digital-watchdog.com/resources>
2. Search your product by the part number. Results will populate automatically based on the part number you enter.

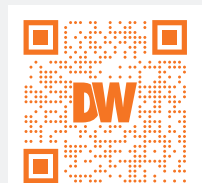

INSTALLATION

- 1 Use the provided mounting template to trace the cut area with a pencil, and mark and drill the hole on the mounting surface.

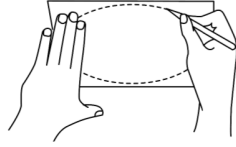

- 2 Pass wires through and make all the necessary connections. Connect to the camera's network. Use the waterproof cap for an added layer of protection from moisture. See the diagram on the right for installation.

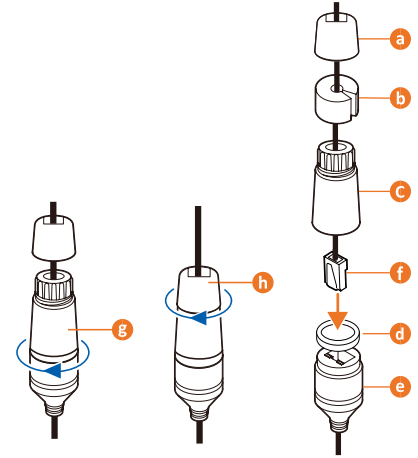

NOTE: The speaker can be powered by PoE or 12V DC. Both power sources CANNOT be used at the same time.

- 3 Test the speaker at a low volume to ensure the connection is secure before final installation.
- 4 Lift the clip on one side and insert it into the mounting surface by tilting it. Then, press the other clip and insert it on the other side to secure the speaker into place.

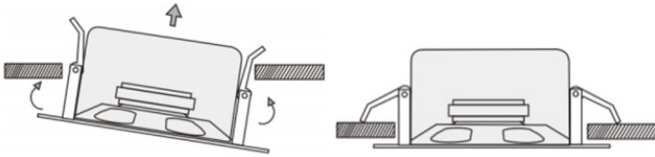

- 5 Complete the speaker's setup using the speaker's web interface. Open a web browser and enter the speaker's IP address.

NOTE:
 Default IP address: 192.168.1.50.
 Default username: admin
 Default password: admin
 (password must be changed during the initial installation)

- 6 Change the IP address to the same subnet range of the cameras.

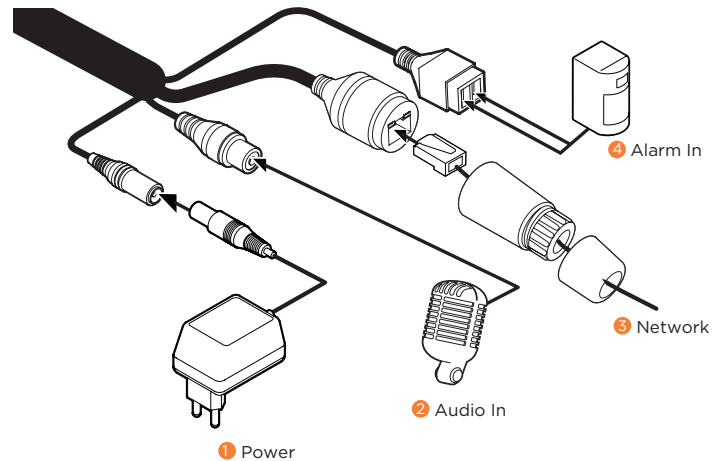

ADDING TO DW SPECTRUM

- 1 Open the DW Spectrum client.
- 2 DW-SWSPC30iAM should be listed under the resource tree if auto-discovery is enabled and the DW Spectrum Mediaserver and the speaker are on the same network.
 * Add the speaker manually if the auto-discovery is disabled.

DIMENSIONS

